

YSR 徑向鎖定

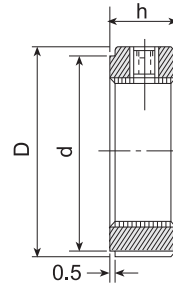
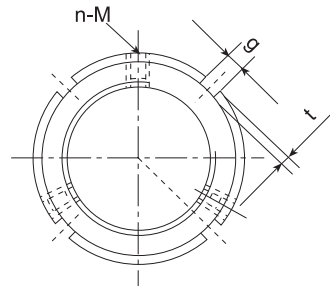

螺 牙 Thread	D	h	g	t	d	n - M	MAX.Nm
YSR M 6X0.5	16	8	3	2	11	2 - M4	3.5
YSR M 8X0.75	18				13		
YSR M 10X0.75	20				16		
YSR M 10X1	25				21		
YSR M 12X1	28	10	4	2	23	2 - M5	4.5
YSR M 12X1.25	30				25		
YSR M 14X1.5	32				27	3 - M5	
YSR M 15X1	35				30		
YSR M 16X1.5	38	12	5	2.5	33	3 - M6	8.0
YSR M 17X1	42				37		
YSR M 18X1.5	45				40		
YSR M 20X1	47				45		
YSR M 20X1.5	52	14	6	2.5	47	3 - M6	8.0
YSR M 22X1.5	55				49		
YSR M 24X1.5	58				52		
YSR M 25X1.5	62				56		
YSR M 27X1.5	65	16	7	3	59	3 - M8	18.0
YSR M 30X1.5	68				62		
YSR M 33X1.5	70				64		
YSR M 35X1.5	73				66		
YSR M 36X1.5	75	18	8	3.5	68	3 - M8	18.0
YSR M 39X1.5	77				70		
YSR M 40X1.5	80				73		
YSR M 42X1.5	85				78		
YSR M 45X1.5	92	20	10	4	84	3 - M8	18.0
YSR M 48X1.5	95				86		
YSR M 50X1.5	98				90		
YSR M 52X1.5	100				92		
YSR M 55X2	105	22	12	5	96	3 - M8	18.0
YSR M 56X2	110				102		
YSR M 60X2	120				108		
YSR M 64X2	125				113		
YSR M 65X2	130	24	14	6	118	3 - M10	35.0
YSR M 68X2	140				125		
YSR M 70X2	145				132		
YSR M 72X2	150				137		
YSR M 75X2	155	26	16	7	142	3 - M10	35.0
YSR M 76X2	160				147		
YSR M 80X2	165				152		
YSR M 85X2	175				160		
YSR M 90X2	180	28	18	8	165	3 - M12	60.0
YSR M 95X2	190				175		
YSR M 100X2	195				180		
YSR M 105X2	200				180		
YSR M 110X2	210	30	18	8	190	3 - M12	60.0
YSR M 115X2	210				190		
YSR M 120X2	220				200		
YSR M 125X2	230				205		
YSR M 130X2	240	32			215	3 - M12	60.0
YSR M 135X2	250				225		

Remarks:(1)The data are for reference only. (2)1 Nm=10.2kgf.cm=0.73lb.ft

YSK 縮緊鎖定

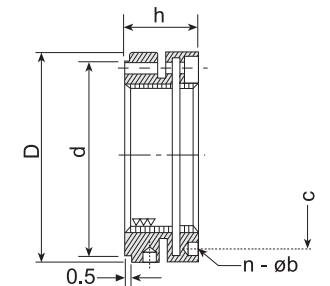
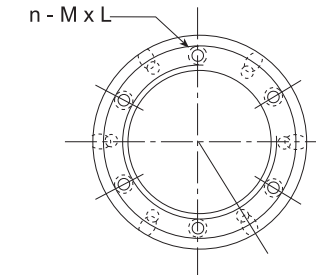

螺 牙 Thread	D	h	g	n - M x L	n	b	c	MAX.Nm
YSK M 16X1.5	34	18	29	4-M4 X 12	4	4	24	3.5
YSK M 17X1	37		32				26	
YSK M 18X1.5	38		33				28	
YSK M 20X1	40		35				30	
YSK M 20X1.5	42	20	37	4-M4 X 14	4	5	32	3.5
YSK M 22X1.5	44		39				34	
YSK M 24X1.5	45		40				35	
YSK M 25X1.5	46		43				37	
YSK M 26X1.5	48	22	45	4-M4 X 16	4	5	39	3.5
YSK M 28X1.5	50		47				41	
YSK M 30X1.5	53		50				44	
YSK M 32X1.5	56		53				47	
YSK M 35X1.5	58	25	55	6-M4 X 18	6	6	49	4.5
YSK M 40X1.5	60		63				51	
YSK M 42X1.5	68		65				58	
YSK M 45X1.5	69		66				60	
YSK M 48X1.5	70	26	68	6-M4 X 18	6	6	62	4.5
YSK M 50X1.5	72		71				65	
YSK M 52X1.5	75		77				70	
YSK M 55X1.5	82		79				72	
YSK M 55X2	84	28	82	6-M5 X 20	6	7	75	8
YSK M 58X1.5	86		84				77	
YSK M 60X1.5	88		87				80	
YSK M 60X2	93		89				82	
YSK M 62X1.5	95	32	91	6-M6 X 22	6	8	84	8
YSK M 65X1.5	97		94				87	
YSK M 65X2	100		103				95	
YSK M 68X1.5	110		108				100	
YSK M 70X1.5	115	34	113	6-M6 X 22	6	8	105	8
YSK M 70X2	120		118				110	
YSK M 72X1.5	125		123				115	
YSK M 75X1.5	130		128				120	
YSK M 75X2	135	36	133	6-M6 X 25	6	8	125	8
YSK M 80X2	140		137				130	
YSK M 85X2	145		146				136	
YSK M 90X2	155		150				140	
YSK M 95X2	160	38	155	8-M6 X 25	8	10	147	18
YSK M 100X2	165		168				160	
YSK M 105X2	180		178				170	
YSK M 110X2	190		190				178	
YSK M 115X2	205	40	200	8-M8 X 30	8	10	193	18
YSK M 120X2	215		213				205	
YSK M 125X2	230		223				215	
YSK M 130X2	240		230				223	
YSK M 140X2	245							

Remarks:(1)The data are for reference only. (2)1 Nm=10.2kgf.cm=0.73lb.ft